

- NOTE:
- EXISTING SERVICES ARE SHOWN BASED ON THE BEST AVAILABLE INFORMATION, BUT SHALL BE REGARDED AS APPROXIMATE ONLY. THE CONTRACTOR SHALL CONFIRM THE POSITION OF ALL UNDERGROUND SERVICES PRIOR TO COMMENCING WORK.
 - THE CONTRACTOR SHALL OBTAIN ALL NECESSARY WAYLEAVES FROM THE RELEVANT SERVICE AUTHORITIES PRIOR TO COMMENCING WORK, AND SHALL LIAISE WITH THE SERVICE AUTHORITIES TO DETERMINE THE SERVICE RELOCATION OR PROTECTION MEASURES REQUIRED.
 - WHERE EXISTING SERVICES ARE AFFECTED BY THE WORKS, THEY SHALL BE EXPOSED BY HAND AND PROTECTED AS DIRECTED BY THE SERVICE AUTHORITY. THIS WORK SHALL BE CARRIED OUT BY THE CONTRACTOR UNDER THE SUPERVISION OF THE SERVICE AUTHORITY.
 - WHERE EXISTING DUCTS ARE ENCOUNTERED, THEY SHALL BE EXTENDED TO 0.5 m BEHIND THE NEW KERBLINE.
 - EXISTING TREES AND VEGETATION ARE TO BE PROTECTED WHEREVER POSSIBLE, AND MAY ONLY BE REMOVED ON THE WRITTEN INSTRUCTION OF THE ENGINEER.
 - DROPPED KERBS ARE TO BE PROVIDED AT ALL DRIVEWAYS AND PEDESTRIAN CROSSINGS.
 - STREET LIGHTING AND BUILDING ELECTRICAL INSTALLATION TO BE CARRIED OUT BY ELECTRICAL SUBCONTRACTOR.
 - EXISTING KERBS, CHANNELS AND PAVING NEEDS TO BE REMOVED AND STOCKPILED FOR RE-USE

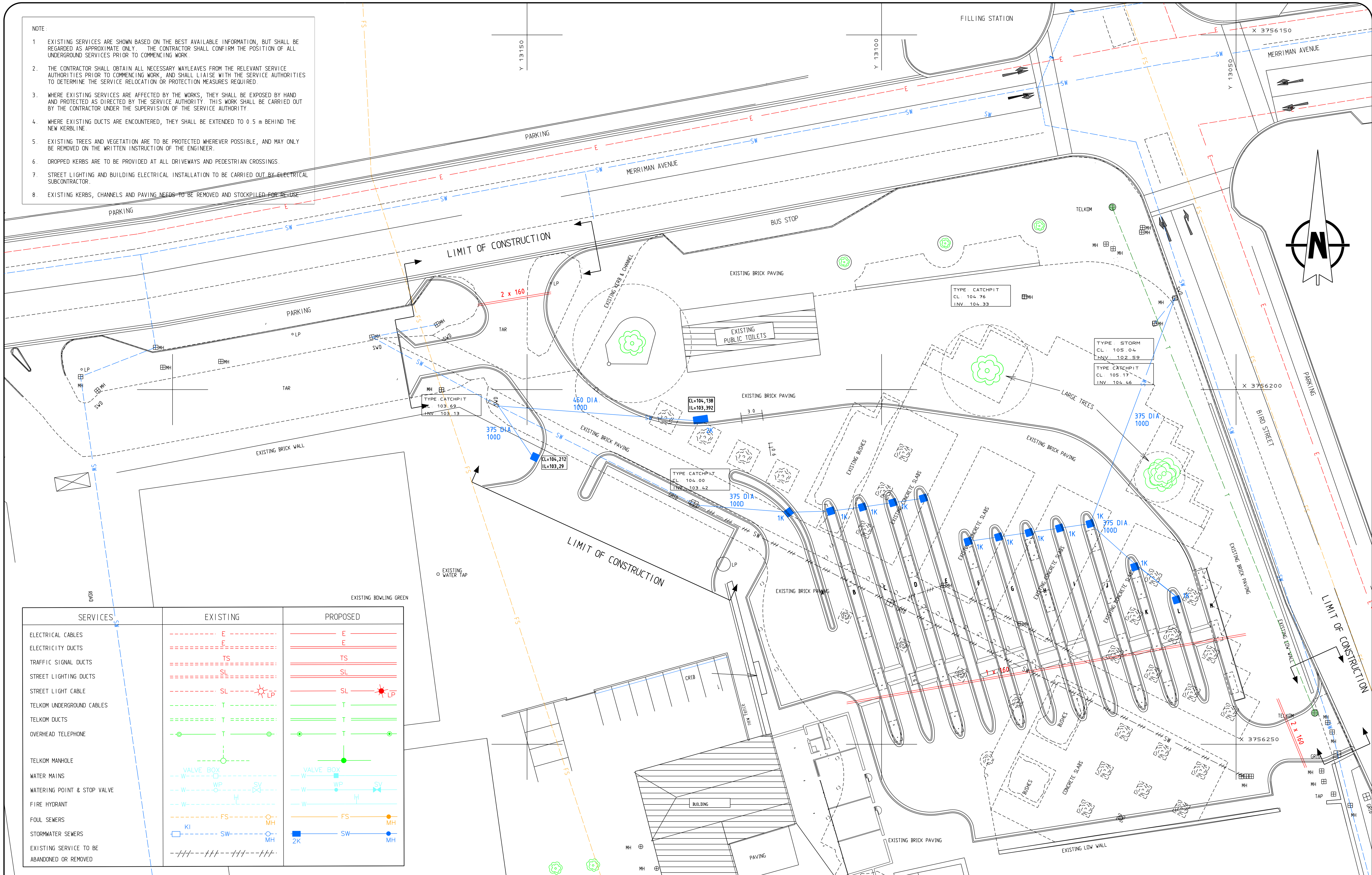

SERVICES	EXISTING	PROPOSED
ELECTRICAL CABLES	---	---
ELECTRICITY DUCTS	---	---
TRAFFIC SIGNAL DUCTS	---	---
STREET LIGHTING DUCTS	---	---
STREET LIGHT CABLE	---	---
TELKOM UNDERGROUND CABLES	---	---
TELKOM DUCTS	---	---
OVERHEAD TELEPHONE	---	---
TELKOM MANHOLE	---	---
WATER MAINS	---	---
WATERING POINT & STOP VALVE	---	---
FIRE HYDRANT	---	---
FOUL SEWERS	---	---
STORMWATER SEWERS	---	---
EXISTING SERVICE TO BE ABANDONED OR REMOVED	---	---

No.	Date	Description	Initial
01	2008-03-31	ISSUED FOR CONSTRUCTION	
00	2007-10-17	DRAWING COMPLETED	

for	VELA VKE	Designed By	A. WITTEN
date		Checked By	J. BASSON
for	CLIENT	Drawn By	A. WITTEN
date		Checked By	A. ROSE INNES

65 RIEBEEK ST.
CAPE TOWN
8001

Tel: (+27 21) 417 2900
Fax: (+27 21) 417 2999

P O BOX 8022
ROGGEBAAI
8012

E-MAIL:
capetown@velavke.co.za

STELLENBOSCH MUNICIPALITY

UPGRADING OF
BERGZICHT TAXI RANK

EXISTING AND PROPOSED SERVICES

A1	Scale	1 : 250
VELA VKE plan no. C1040-T-C-002		
Client plan no.		
Revision No.	0001	